



Alan Lambe
Donnachadh O' Brien & Associates Consulting Engineers
Unit 5C
Elm House
Millenium Park
Naas
Co. Kildare
W91P9P8

Uisce Éireann
Bosca OP 448
Oifig Sheachadta na
Cathrach Theas
Cathair Chorcaí

Irish Water
PO Box 448,
South City
Delivery Office,
Cork City.

www.water.ie

26 October 2022

**Re: Design Submission for Finlay Park, Naas, Kildare (the “Development”)
(the “Design Submission”) / Connection Reference No: CDS22004436**

Dear Alan Lambe,

Many thanks for your recent Design Submission.

We have reviewed your proposal for the connection(s) at the Development. Based on the information provided, which included the documents outlined in Appendix A to this letter, Irish Water has no objection to your proposals.

This letter does not constitute an offer, in whole or in part, to provide a connection to any Irish Water infrastructure. Before you can connect to our network you must sign a connection agreement with Irish Water. This can be applied for by completing the connection application form at www.water.ie/connections. Irish Water’s current charges for water and wastewater connections are set out in the Water Charges Plan as approved by the Commission for Regulation of Utilities (CRU)(https://www.cru.ie/document_group/irish-waters-water-charges-plan-2018/).

You the Customer (including any designers/contractors or other related parties appointed by you) is entirely responsible for the design and construction of all water and/or wastewater infrastructure within the Development which is necessary to facilitate connection(s) from the boundary of the Development to Irish Water’s network(s) (the “**Self-Lay Works**”), as reflected in your Design Submission. Acceptance of the Design Submission by Irish Water does not, in any way, render Irish Water liable for any elements of the design and/or construction of the Self-Lay Works.

If you have any further questions, please contact your Irish Water representative:

Name: Antonio Garzón

Email: antonio.garzon@water.ie

Yours sincerely,

Yvonne Harris
Head of Customer Operations

Appendix A

Document Title & Revision

- C-0031 Proposed Foul and Surface Water Layout P03
- C-0040 Proposed Watermain Layout P05
- C-0141 Proposed Long Sections P03

Additional Comments

The design submission will be subject to further technical review at connection application stage.

Irish Water cannot guarantee that its Network in any location will have the capacity to deliver a particular flow rate and associated residual pressure to meet the requirements of the relevant Fire Authority, see Section 1.17 of Water Code of Practice.

For further information, visit www.water.ie/connections

Notwithstanding any matters listed above, the Customer (including any appointed designers/contractors, etc.) is entirely responsible for the design and construction of the Self-Lay Works. Acceptance of the Design Submission by Irish Water will not, in any way, render Irish Water liable for any elements of the design and/or construction of the Self-Lay Works.

GENERAL NOTES:

- FOR STANDARD DOBA NOTES REFER TO DRAWING 2110-S00.1
- THIS DRAWING IS TO BE READ IN CONJUNCTION WITH ALL OTHER RELEVANT ENGINEER'S DRAWINGS AND SPECIFICATIONS.
- USE FIGURED DIMENSIONS ONLY. DO NOT SCALE
- THE CONTRACTOR SHALL VERIFY ALL DIMENSIONS AND LEVELS WITH ENGINEERING DRAWINGS PRIOR TO START OF CONSTRUCTION. ANY DISCREPANCIES TO BE NOTIFIED TO THE ENGINEER FOR RESOLUTION.
- CONTRACTOR IS RESPONSIBLE FOR ANY NECESSARY CONDITION SURVEY OF THE WORKS AREA, PUBLIC ROADS AND RETURN TO ORIGINAL CONDITION FOLLOWING WORKS
- CONTRACTOR TO ALLOW FOR SCANNING AND GPR SURVEY OF THE SITE FOR ANY UNDERGROUND SERVICES PRIOR TO WORKS, REFER TO PUBLIC UTILITIES DRAWINGS FOR APPROXIMATE LOCATION OF EXISTING SERVICES

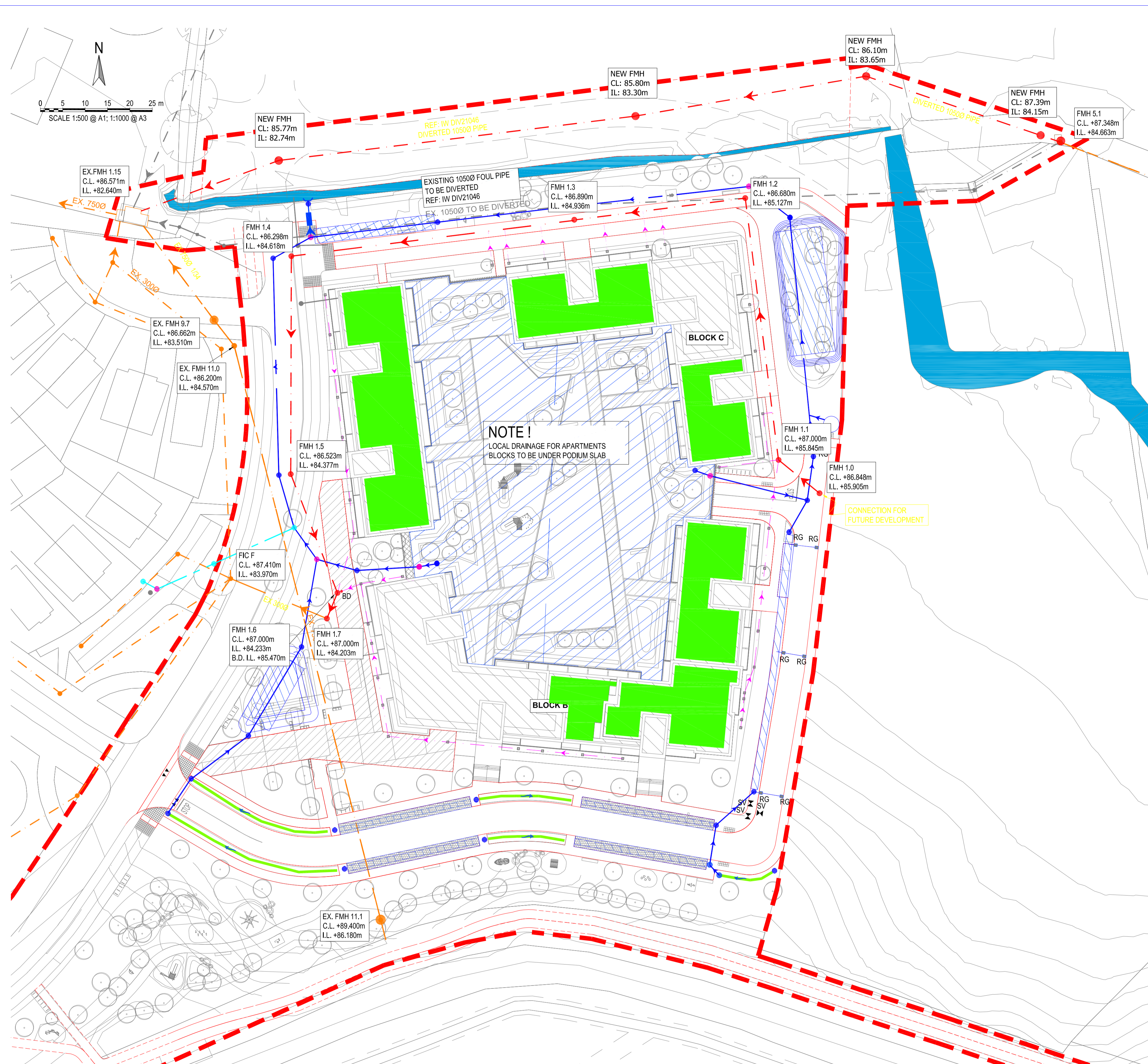

FOUL WATER LEGEND:

- EXISTING FOUL SEWER
- PR. PHASE 1 FOUL DRAINAGE
- EXISTING FOUL DRAINAGE TO BE DIVERTED
- PROPOSED FOUL WATER MH
- PROPOSED FOUL WATER INSPECTION CHAMBER
- PROPOSED BACKDROP IN MH
- PROPOSED UNDERSLUNG LOCAL DRAINAGE (TYPICAL)
- PROPOSED LOCAL DRAINAGE (TYPICAL)

SURFACE WATER LEGEND:

- EXISTING SURFACE WATER
- PROPOSED SURFACE WATER DRAINAGE
- PR. INFILTRATION TRENCH
- PR. SWALE
- PROPOSED SURFACE WATER MH
- PR. TREE PIT
- PR. ATTENUATION TANK
- PR. PERMEABLE PAVING AREAS
- EXISTING WATERCOURSE
- PR. BLUE ROOF
- PR. GREEN ROOF
- PR. GREEN WALL

- NOTE 1:** MANHOLE COVER LEVELS ARE APPROXIMATE. ACTUAL COVER LEVELS SHOULD MATCH SURROUNDING FINISHED GROUND LEVELS U.N.O.
- NOTE 2:** PIPES WITH LESS COVER THAN
- 600mm FOR GRASSED AREAS
 - 900mm FOR FOOTPATHS
 - 1200mm FOR ROADS
- TO BE SURROUNDED IN 150mm CONCRETE PROTECTION IN ACCORDANCE WITH IRISH WATER STANDARD DETAIL STD-WW-07
- NOTE 3:** ALL MANHOLE COVERS LOCATED IN GRASS AREAS TO BE SURROUNDED (Min. 200mm SURROUND) IN 100mm THK C20/25 CONCRETE APRON

- NOTE 1:** MANHOLE COVER LEVELS ARE APPROXIMATE. ACTUAL COVER LEVELS SHOULD MATCH SURROUNDING FINISHED GROUND LEVELS U.N.O.
- NOTE 2:** PIPES WITH LESS COVER THAN
- 600mm FOR GRASSED AREAS
 - 900mm FOR FOOTPATHS
 - 1200mm FOR ROADS
- TO BE SURROUNDED IN 150mm CONCRETE PROTECTION IN ACCORDANCE WITH IRISH WATER STANDARD DETAIL STD-WW-07
- NOTE 3:** ALL MANHOLE COVERS LOCATED IN GRASS AREAS TO BE SURROUNDED (Min. 200mm SURROUND) IN 100mm THK C20/25 CONCRETE APRON

FOUL PIPE MATERIAL TO BE IN ACCORDANCE WITH IW-CDS-5030-03 SECTION 3.13.2

- 3.13.2 THERMOPLASTIC STRUCTURAL WALL PIPES; THERMOPLASTIC STRUCTURED WALL PIPES SHALL COMPLY WITH THE PROVISIONS OF IS EN 13476 (2007/2009). PIPES TO BE OF STIFFNESS CLASS 8kN/m² & TO BE CAPABLE OF DEMONSTRATING A JETTING RESISTANCE OF 2,600 PSI (180 BAR) WITHOUT DAMAGE. WHEN TESTED IN ACCORDANCE WITH SECTION 3.3 OF WIS 4-35-01 (2008). (SEWER DIAMETERS 150mm UP TO 450mm, SERVICE CONNECTIONS OF 100mm DIAMETER).

SURFACE WATER MATERIAL TO BE IN ACCORDANCE WITH GREATER DUBLIN REGIONAL CODE OF PRACTICE FOR DRAINAGE WORKS

- UNPLASTICISED P.V.C. PIPES MUST COMPLY WITH THE "PROVISIONAL SPECIFICATION FOR SOIL PIPES, DRAINS, SEWERS & FITTINGS MADE OF UNPLASTICISED P.V.C." ISSUED BY THE DEPARTMENT OF THE ENVIRONMENT.
- B.S. 8005: PART 1 - SEWERAGE OR EQUIVALENT;
- B.S. 8010: PART 2 - PIPELINES ON LAND OR EQUIVALENT: DESIGN, CONSTRUCTION & INSTALLATION;
- B.S. 5955: PART 6 CODE OF PRACTICE FOR THE INSTALLATION OF UNPLASTICISED P.V.C. PIPEWORK FOR GRAVITY DRAINS & SEWERS OR EQUIVALENT
- EN1401 - UNPLASTICISED P.V.C. SEWER PIPE SPECIFICATION
- B.S.4514 - UNPLASTICISED P.V.C. SOIL PIPE SPECIFICATION
- DoEHLG SITE DEVELOPMENT WORKS' & SECTION H OF THE BUILDING REGULATIONS

DRAFT ISSUE

S2.P03	DRAFT ISSUE	18.10.2022	SP	AL
S2.P02	DRAFT ISSUE	07.10.2022	NQ	AL
S2.P01	PRE-PLANNING ISSUE	02/09/2022	BB	AL
Rev.	Note	Date	Drawn	Check

DONNACHADH O'BRIEN & ASSOCIATES CONSULTING ENGINEERS

UNIT 5C
ELM HOUSE
MILLENNIUM PARK
NAAS
CO. KILDARE

PHONE
+353 45 984 042

INFO@DOBRIEN-ENGINEERS.IE
WWW.DOBRIEN-ENGINEERS.IE

Client: WESTAR HOMES LTD.

Project: FINLAY PARK

Drawing Title: PROPOSED FOUL AND SURFACE WATER LAYOUT

Drawn By: MF	Checked By: AL	Approved By: DOB	Date: MAR'2021	Scale: 1:500	Sheet Size: A1
Project Number: DOBA2110	Drawing Number: FINLAY-DOB-XX-SI- DR -C-0031	Status Code: S2	Rev Number: P03		

GENERAL NOTES:

1. FOR STANDARD DOBA NOTES REFER TO DRAWING 2110-S00.1
2. THIS DRAWING IS TO BE READ IN CONJUNCTION WITH ALL OTHER RELEVANT ENGINEER'S DRAWINGS AND SPECIFICATIONS.
3. USE FIGURED DIMENSIONS ONLY. DO NOT SCALE
4. THE CONTRACTOR SHALL VERIFY ALL DIMENSIONS AND LEVELS WITH ENGINEERING DRAWINGS PRIOR TO START OF CONSTRUCTION. ANY DISCREPANCIES TO BE NOTIFIED TO THE ENGINEER FOR RESOLUTION.
5. CONTRACTOR IS RESPONSIBLE FOR ANY NECESSARY CONDITION SURVEY OF THE WORKS AREA, PUBLIC ROADS AND RETURN TO ORIGINAL CONDITION FOLLOWING WORKS
6. CONTRACTOR TO ALLOW FOR SCANNING AND GPR SURVEY OF THE SITE FOR ANY UNDERGROUND SERVICES PRIOR TO WORKS, REFER TO PUBLIC UTILITIES DRAWINGS FOR APPROXIMATE LOCATION OF EXISTING SERVICES

WATERMAIN LEGEND:

- EXISTING WATERMAIN
 - - - PROPOSED WATERMAIN
 - (H) PROPOSED HYDRANT
 - (M) PROPOSED BOUNDARY BOX
 - (BM) PROPOSED BULK WATER METER
 - AV PROPOSED AIR VALVE
 - SV PROPOSED SLUICE VALVE
 - SCV PROPOSED SCOUR VALVE
 - SCCH SCOUR CHAMBER
- THRUST BLOCKS OMITTED FOR CLARITY, TO BE INSTALLED AS PER I.W. TYPICAL DETAILS

WATERMAIN MATERIAL TO BE IN ACCORDANCE WITH IW-CDS-5020-03 SECTION 3.9.2

- 3.9.2 MDPE & HDPE PIPES SHALL BE OF A TYPE PE-80 & HAVE AN SDR-11 OR SDR-17 RATING. THEY SHALL CONFORM TO IS EN 12201:PART 1 & PART 2 (PLASTIC SYSTEMS FOR WATER SUPPLY, DRAINAGE & SEWERAGE UNDER PRESSURE - PART 1, GENERAL, & PART 2, PIPES) & IS, EN 12201-3 (PLASTIC SYSTEMS FOR WATER SUPPLY, DRAINAGE & SEWERAGE UNDER PRESSURE - PART 3: FITTINGS).
- PROTECTION OF WATERMAIN TO BE IN ACCORDANCE WITH IRISH WATER STANDARD DETAIL STD-W-12A AND SECTION 3.26 OF THE IRISH WATER CODE OF PRACTICE

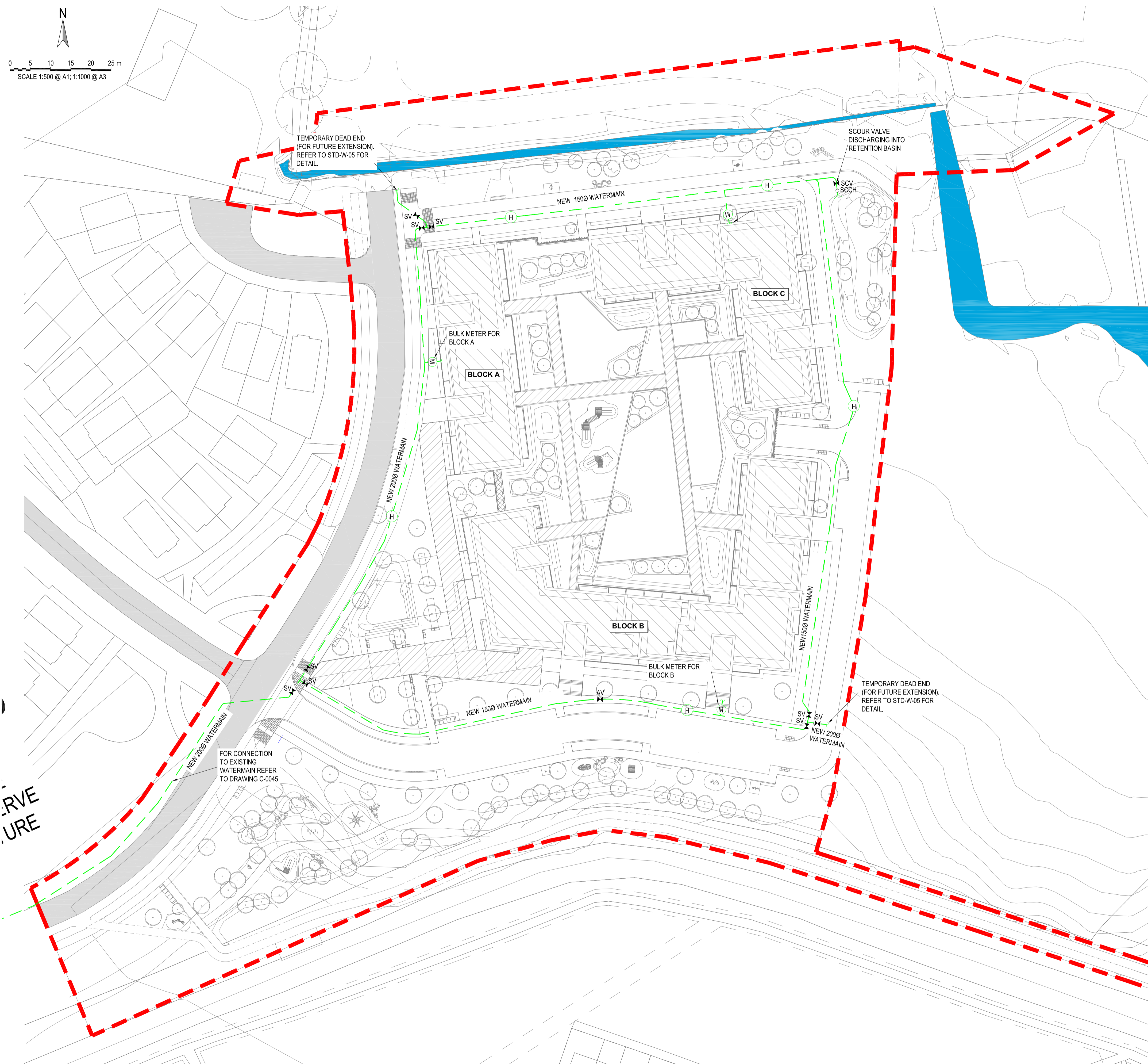
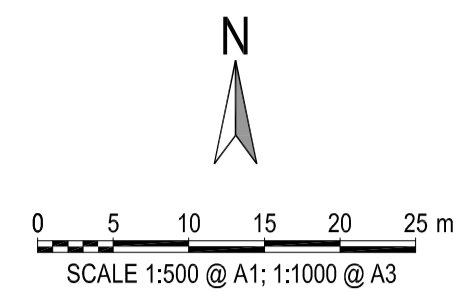

DRAFT ISSUE

S2.P05	DRAFT ISSUE	18/10/2022	SP	AL
S2.P04	DRAFT ISSUE	11/10/2022	NQ	AL
S2.P03	DRAFT ISSUE	07/10/2022	NQ	AL
S2.P02	DRAFT ISSUE	06/10/2022	NQ	AL
S2.P01	PRE-PLANNING ISSUE	02/09/2022	BB	AL
Rev.	Note	Date	Drawn	Check

<p>DONNACHADH O'BRIEN & ASSOCIATES CONSULTING ENGINEERS</p>	<p>UNIT 5C ELM HOUSE MILLENNIUM PARK NAAS CO. KILDARE</p>	<p>PHONE +353 45 984 042 INFO@DOBRIEN-ENGINEERS.IE WWW.DOBRIEN-ENGINEERS.IE</p>
--	---	---

Client:	WESTAR HOMES LTD.				
Project:	FINLAY PARK				
Drawing Title:	PROPOSED WATERMAIN LAYOUT				
Drawn By:	Checked By:	Approved By:	Date:	Scale:	Sheet Size:
MF	AL	DOB	MAR/2021	1:500	A1
Project Number:	DOBA2110	Drawing Number:	FINLAY -DOB- XX-SI- DR -C-0040	Status Code:	Rev Number:
				S2	P05

