

# DESIGN INTENT DRAWING

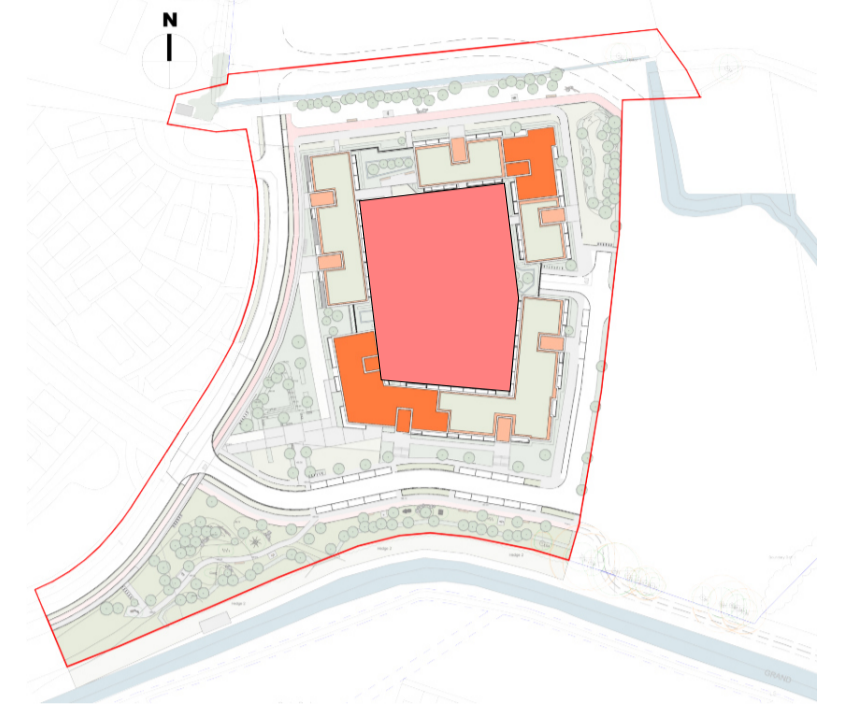

## PART V

RED HATCH INDICATES THE PARKING LOCATION TO BE HANDED OVER FOR PART V.

IT IS PROPOSED TO PROVIDE 14 UNITS FOR PART V COMPLIANCE.

- (04) 1 BED APARTMENT
- (08) 2 BED DUPLEX APARTMENT
- (02) 3 BED DUPLEX APARTMENT

THE PROPOSAL INCLUDES 18 PARKING SPACES (ON THE BASIS OF 1.3 SPACES PER UNIT) AND 28 BIKE SPACES FOR RESIDENTS (ON THE BASIS OF 2 SPACE PER UNIT).

Rev	Date	Description	Issued By
P01	06/12/2022	Planning Issue	

Project Stage  
**PLANNING**

Client:  
Westar Homes Limited

Project:  
Residential @ Finlay Park  
Finlay Park, Naas, Co. Kildare

Drawing Title:  
Zone 1 - Podium Carparking - Part V

Drawn	Checked	Paper Size	Scale	Date
VM	BB	A1	As indicated	06/12/2022

Project No.	Drawing No.	Classification	Revision
PE17019	2012		P01

File Name:  
PE17019-CWO-01-00-DR-A-2012

Status:  
Suitable for planning



No.1 Sarsfield Quay, Dublin 7, D07 R9FH  
t: 01 518 0170 e: admin@cwoarchitects.ie  
Dublin | Cork | Galway | London | UK & Europe +  
www.cwoarchitects.ie



1 00 - Zone 1 - Podium Carparking - Part V 1:200