

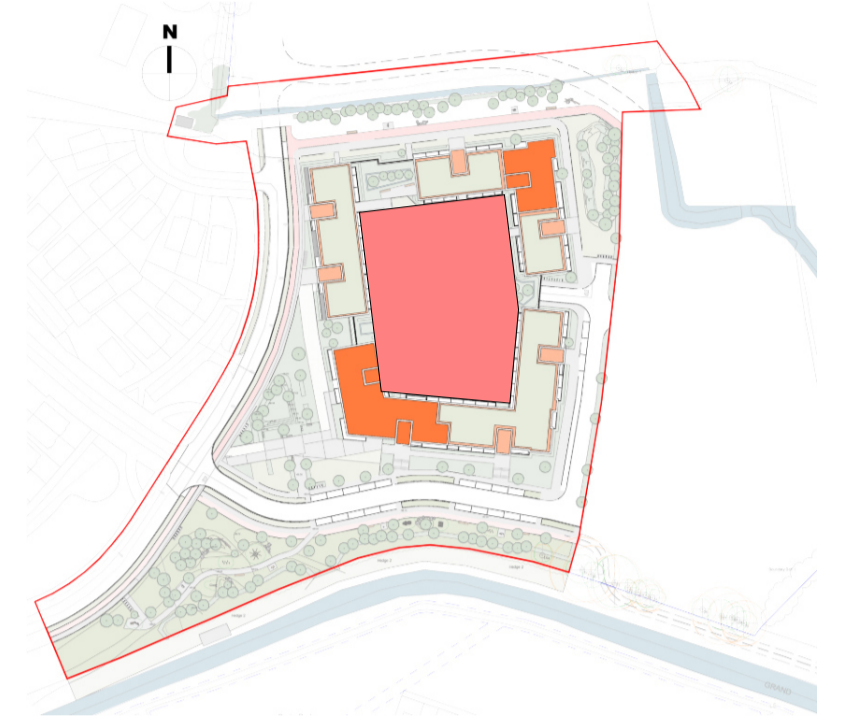

THE COPYRIGHT OF THIS DRAWING IS VESTED WITH CW O'BRIEN ARCHITECTS LIMITED AND MUST NOT BE COPIED OR REPRODUCED WITHOUT THE CONSENT OF THE COMPANY.
 FIGURED DIMENSIONS ONLY TO BE TAKEN FROM THIS DRAWING. DO NOT SCALE.
 ALL CONTRACTORS MUST VISIT THE SITE AND BE RESPONSIBLE FOR CHECKING ALL SETTING OUT DIMENSIONS AND NOTIFYING THE ARCHITECT OF ANY DISCREPANCIES PRIOR TO ANY MANUFACTURE OR CONSTRUCTION WORK.
 NOTES:

DESIGN INTENT DRAWING

*Lighting report/drawings will be included it at planning stage



Car Parking Schedule			
Residents - Car Parking Schedule		Quantity	
Unit Description	No. of Units	Spaces x Unit	Proposed No. Spaces
Duplex Apartments	70	1.30	85
Apartments	64	1.30	94
Total	134		179
Visitors/Commercial			22
Grand Total			201

Notes:

Passive Security Features:

- Adequate overall lighting
- Well demarcated pedestrian walkways areas
- Visible parking areas creating an open environment.
- Future Security system for residents will be proposed, designed for a specialist contractor and coordinated with the management company.

P01	06/12/2022	Planning Issue	
Rev	Date	Description	Issued By

Project Stage
PLANNING

Client:
 Westar Homes Limited

Project:
 Residential @ Finlay Park
 Finlay Park, Naas, Co. Kildare

Drawing Title:
 Zone 1 - Podium Carparking

Drawn	Checked	Paper Size	Scale	Date
VM	BB	A1	As indicated	06/12/2022
Project No.	Drawing No.	Classification	Revision	
PE17019	2000		P01	

File Name:
 PE17019-CWO-01-00-DR-A-2000

Status:
 Suitable for planning



No.1 Sarsfield Quay, Dublin 7, D07 R9FH
 t: 01 518 0170 e: admin@cwoarchitects.ie
 Dublin | Cork | Galway | London | UK & Europe +
 www.cwoarchitects.ie

Please consider the environment before printing this sheet

1 00 - Zone 1 - Podium Carparking 1:200